



Expressions of Interest for Skate Park, St Ann's Chapel

clerk@calstockparishcouncil.gov.uk

01822 748847

Published November 2022,
Expressions of Interest to be reviewed March 2023.



Calstock Parish Council

St Ann's Chapel Skate Park

Introduction

St Ann's Chapel is a village in the parish of Calstock and is situated on the main A390. Following the expansion of the village with the construction of housing at Double White Rise and Wain Homes St Ann's Chapel is now the largest conurbation within the Parish.

Until recently St Ann's Chapel also had a wooden constructed Skate Park, however due to irreparable damage the structure was removed for safety reasons. The Parish Council is committed to replacing the old Skate Park with a suitably designed and constructed concrete Skate Park.

Calstock Parish Council is asking for Expressions of Interest with the possibility of work commencing in 2024 or sooner if funding can be secured and subject to a satisfactory contract, contractor availability and any weather opportunity/restrictions.

This document lists general information regarding the project and invites interested commercial enterprises with experience in skate park installations to contact the Parish Council for further information and an opportunity to look at the site. A location plan and existing site pictures are included in the appendix.

General Information

St Ann's Chapel sits within the Cornwall & West Devon Mining and Heritage Site and borders the Tamar Valley AONB it is also the largest of the Villages within Calstock Parish, with the Parish having a population of 6431 (UK Census 2022). As well as St Ann's Chapel, other settlements in the parish include Albaston, Chilsworthy, Gunnislake, Harrowbarrow, Latchley, Metherell, Coxpark, Dimson, Drakewalls, Norris Green, Rising Sun and Calstock.

Aspirations

Calstock Parish Council is committed to replacing the old Skate Park as it is recognised how important this type of sporting structure is to both young and old alike, particularly the 6-26 age groups. The Parish Council has already completed a recreations survey within the Parish which demonstrates evidence that a replacement Skate Park is needed. The Parish Council also have a design which has been completed with community involvement and welcomes amendments to the design which could include seating, safety signage, etc. However, it is expected that the tendering companies would meet and discuss likely proposals with users and the Council.

The Site

The current site has a concrete base approximately 12.7x13 meters and it is hoped that the original concrete base could be reused. Access is from the car park which can be closed off or restricted if need be.

Finance

Calstock Parish Council is working on a budget assumption of the cost being in the range of £100,000-£150,000. The submitted EOI would need to include a confirmation on how long the quote would be valid for along with RoSPA Playground Inspection included before handover of build.



Calstock Parish Council

St Ann's Chapel Skate Park

Submitting the EOI

Calstock Parish Council welcomes enquiries from commercial entities with a background in installing skate parks who wish to be considered for tender. **All submitted Expressions of Interest will be reviewed at the end of December 2022– IT WOULD BE USEFUL (but not imperative) TO HAVE A GUIDE PRICE AT THIS TIME to move the process forward.** In your EOI please detail your

- Contact information
- Business registration number
- Company profile
- Statement of capability, including relevant experience and technical expertise
- Knowledge and availability of skate park installation
- References

Please contact Clare Bullimore, Deputy Clerk at clerk@calstockparishcouncil.gov.uk or 01822 748847.

Appendix

Location:

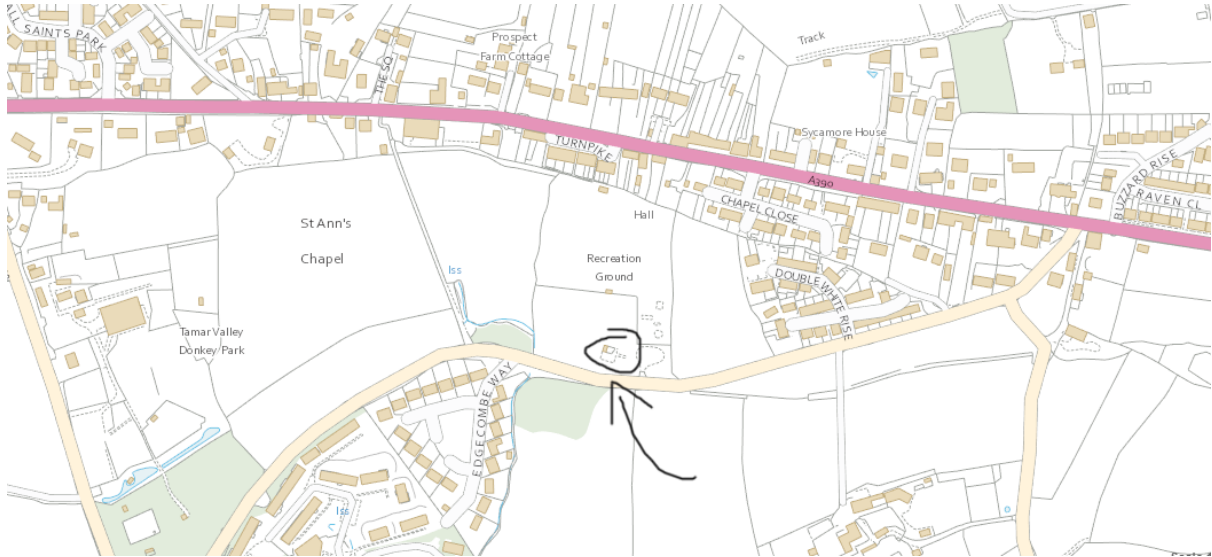



Calstock Parish Council
St Ann's Chapel Skate Park





Calstock Parish Council
St Ann's Chapel Skate Park





Calstock Parish Council

St Ann's Chapel Skate Park

Design:

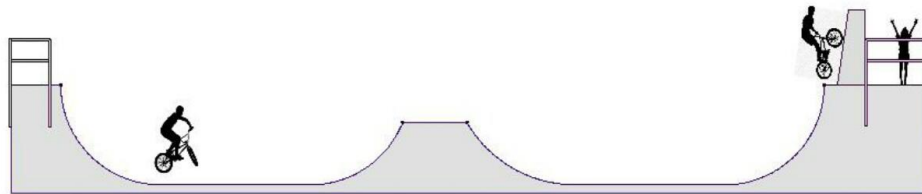

South elevation

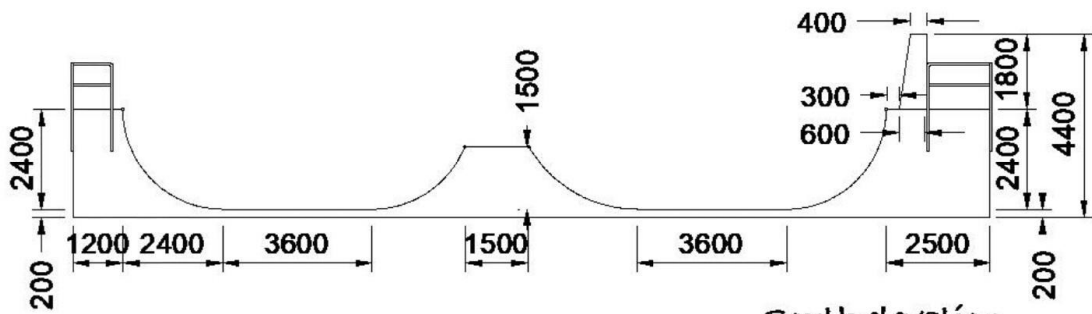

South elevation

St. Ann's Chapel: proposed ramp

Scale: 1:100



Calstock Parish Council

St Ann's Chapel Skate Park

ST ANNS CHAPEL SKATEPARK

George 5th playfeild ,
St Anns Chapel ,

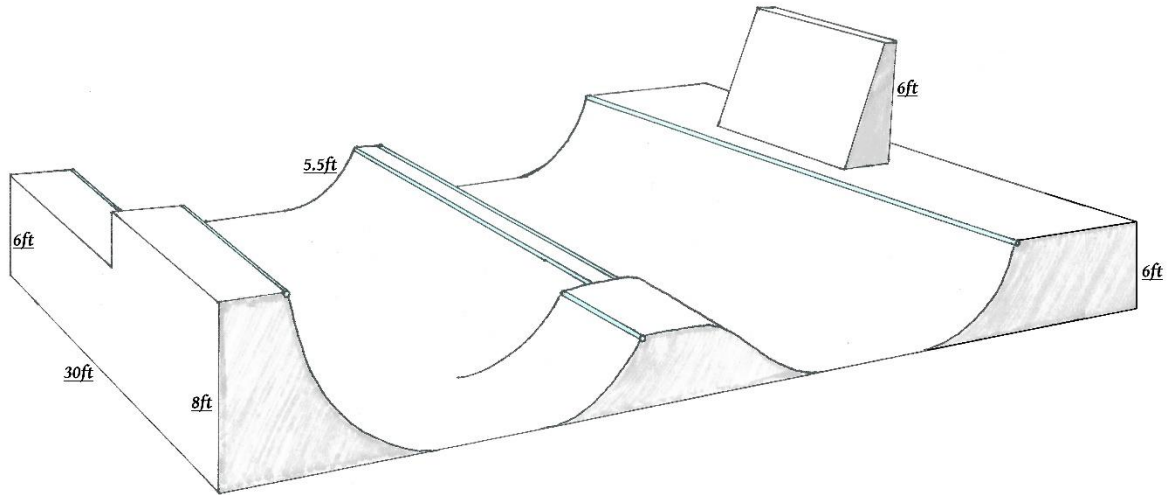

Ben Dance 03,09,08

Not to scale
Shown with no handrails for clarity



Calstock Parish Council
St Ann's Chapel Skate Park

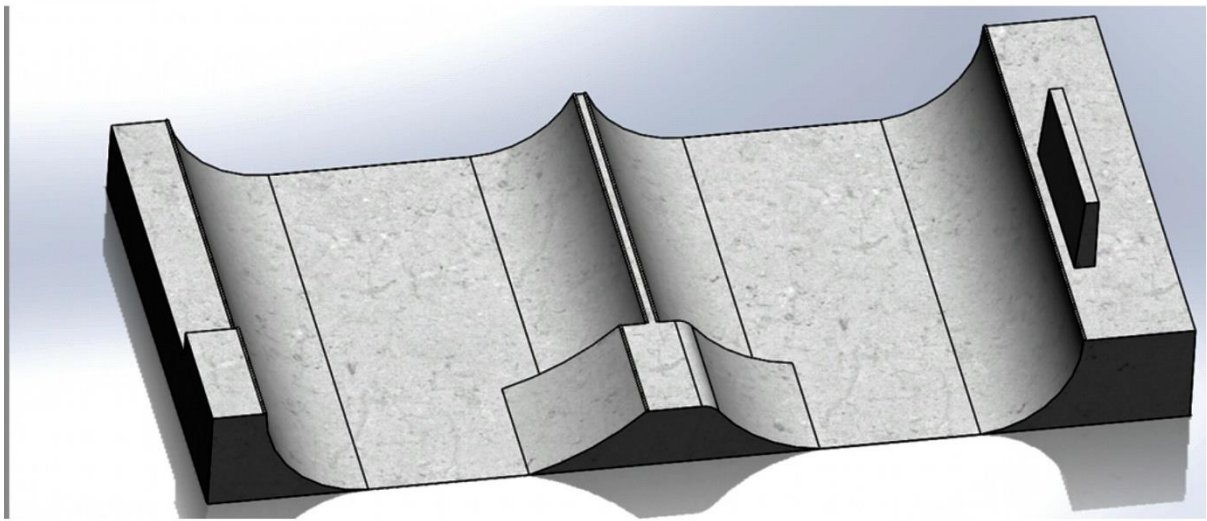
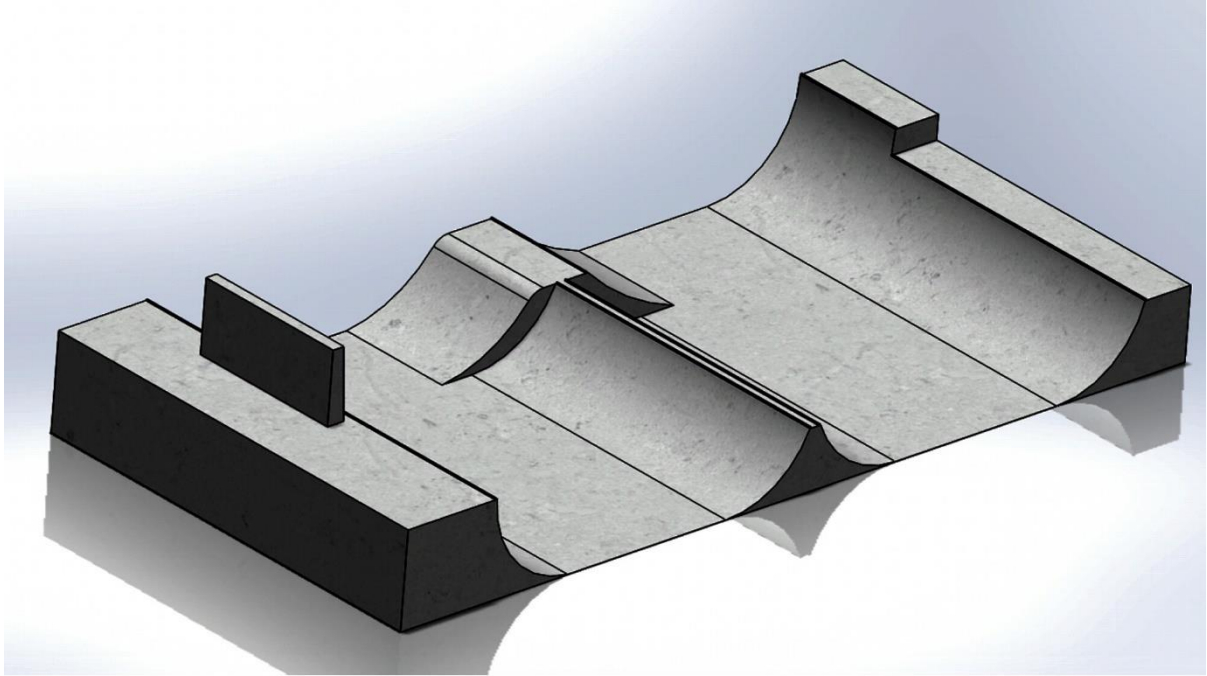



Calstock Parish Council St Ann's Chapel Skate Park

Current design is aimed to cater for all wheeled users, and provides a contrast between Callington and Tavistock ramps, (the two ramps currently closest to the area) that currently exist.

